

Sec. 8-1 - Setback Illustrations:

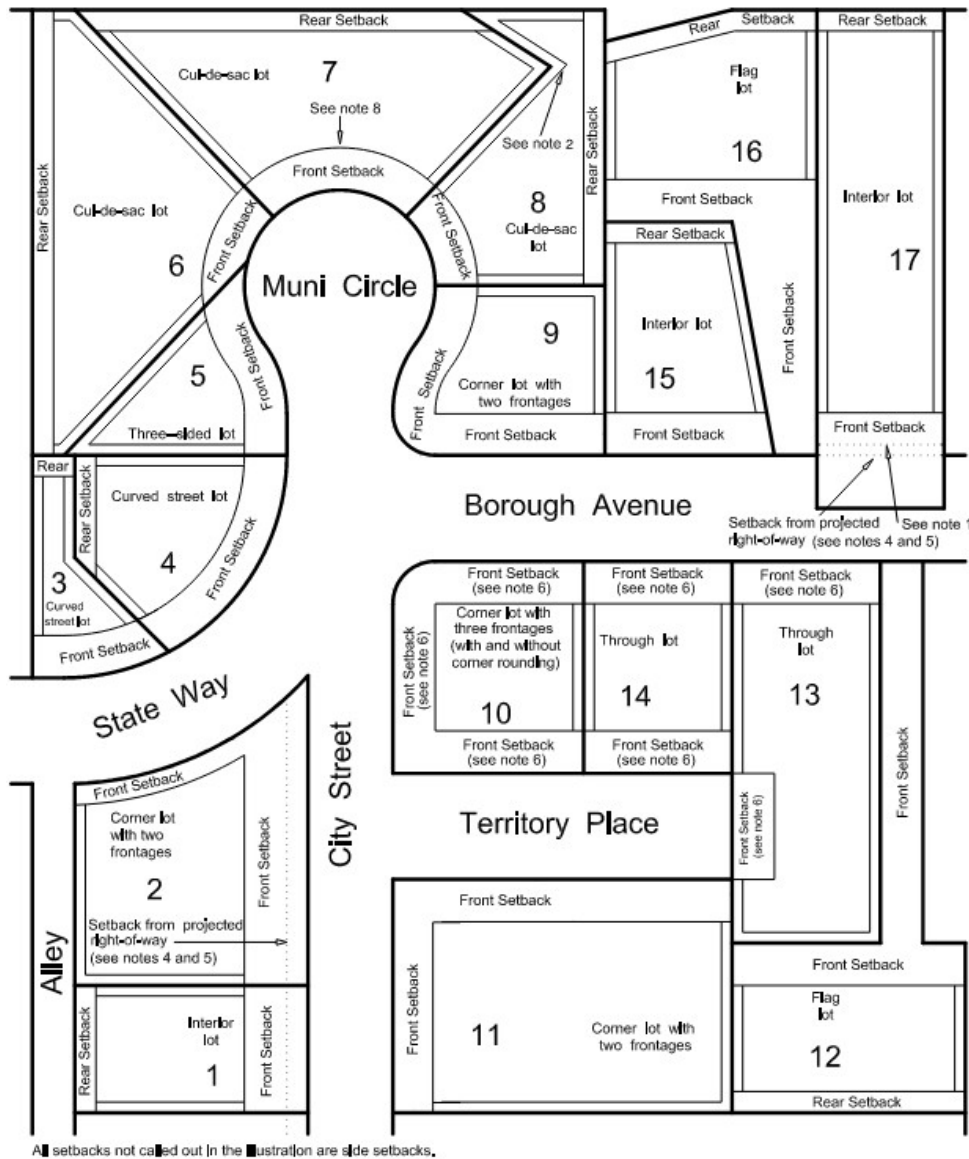

1. Section line easement, road or public use easement.
2. Side setbacks are extended to intersection.
3. In the case of corner, through, and three-sided lots, there will be no rear setbacks, but only front and side setbacks.
4. The area between the property line and the setback from projected right-of-way is subject to the same regulations as a front setback.
5. The front setback is measured from the setback from projected right-of-way.
6. The Schedule in section 8 shall determine the depth of the front setbacks. Full depth setbacks apply on all frontages.
7. The front setbacks are determined by section 8, in accordance with the prevailing setback pattern.
8. The setback follows the curve of the lot line.